

# HLF RANGE HORIZONTAL LAMINAR FLOW CABINETS

PRODUCT SHEET NO. 620  
VERSION 2.0



WORK STATION PROVIDING BETTER THAN ISO 5 AND EC GMP GRADE A AIR QUALITY. FLOW OF AIR IS UNIDIRECTIONAL AND TOWARDS THE OPERATOR TO ENSURE CLEAN 'FIRST AIR' IN WORKING ZONE

## Applications

- Hospital pharmacy operations such as preparing TPN and IV bags.
- Laboratory plant tissue work where sterility of the work is essential.
- Pharmaceutical handling of powders or liquids where sterility is required and the operation presents no hazard to the operator.
- Assembly/manufacture of micro-electronics components.
- Precise mechanical assembly of inertial platforms, hard disc drives etc.

## Principle Design Features

- Unidirectional air flow
- Variable speed super silent fans
- Helps clean up room air
- No effect on room pressures
- Easy to install
- Available on a mobile frame for convenient movement
- Sterile air conditions within minutes of starting
- DOP Test Port
- Inexpensive to purchase and to operate
- Clear Side Screens



Variable speed super silent fans



Mobile frame option available

## Standards compliance:

BS EN ISO 14644 Class 3, 4 or 5  
depending on main filter

EC GMP Class A

# HLF RANGE HORIZONTAL LAMINAR FLOW CABINETS

## DIMENSIONS / SPECIFICATION AND OPTIONS

Model	A mm	B mm	C mm	D mm	Air Volume Handled		Approx Weight kg	Power UK kw	FLC Amps
					m <sup>3</sup> /h	(cfm)			
HLF3B	970	895	590	1100	918	(540)	118	1.44	6
HLF4B	1270	1200	590	1100	1224	(720)	135	1.44	6
HLF5B	1580	1500	590	1100	1530	(900)	147	1.44	6
HLF6B	1880	1800	590	1100	1836	(1080)	216	2.64	11
HLF3BE	970	895	742	1252	1148	(675)	135	1.44	6
HLF4BE	1270	1200	742	1252	1530	(900)	155	2.64	11
HLF5BE	1580	1500	742	1252	1913	(1125)	187	2.64	11
HLF6BE	1880	1800	742	1252	2295	(1350)	235	2.64	11

Materials of Construction	<ul style="list-style-type: none"> <li>The HLF range can be specified in the following materials of construction:-               <ul style="list-style-type: none"> <li>- High quality white laminated mineral board</li> <li>- White polyester painted mild steel</li> <li>- Stainless steel</li> </ul> </li> </ul>
Lighting	<ul style="list-style-type: none"> <li>Min 500 Lux at working level</li> </ul>
Electrical Supply	<ul style="list-style-type: none"> <li>220/240V single phase or any other international requirement.</li> </ul>
Instrumentation and Controls	<ul style="list-style-type: none"> <li>Fans on/off switch/indicator</li> <li>Lights on/off switch</li> <li>Solid state fan speed controller</li> </ul>

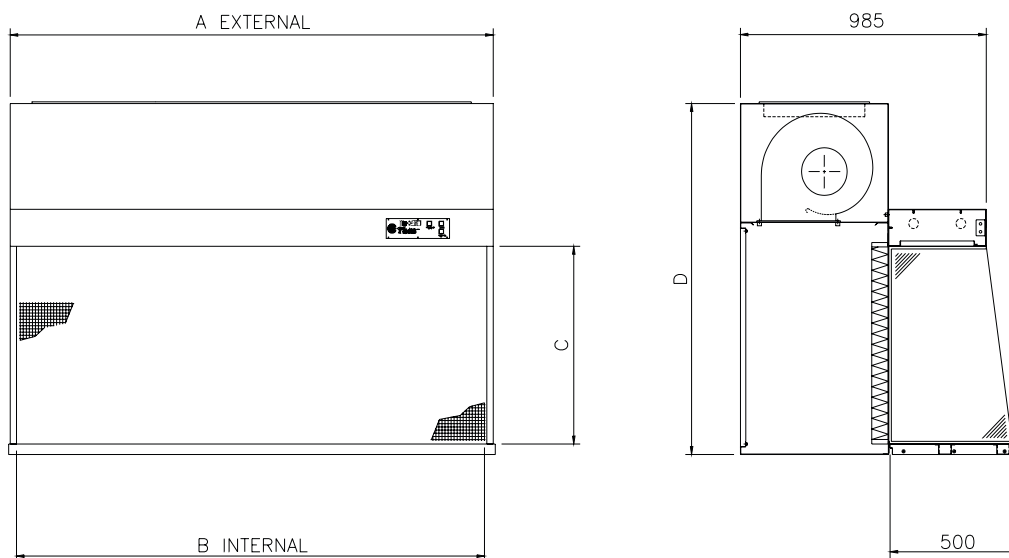

We reserve the right to change any part of this brochure, product or service information, or this legal notice at any time without notice. Any third party or third party products referred to or featured should not in any way be taken as a recommendation or an endorsement of the third party or the third party product. Whilst reasonable care has been taken in compiling this brochure, it may include inaccuracies or typographical errors.